

TECTUM ROOF DECK OVER STEEL

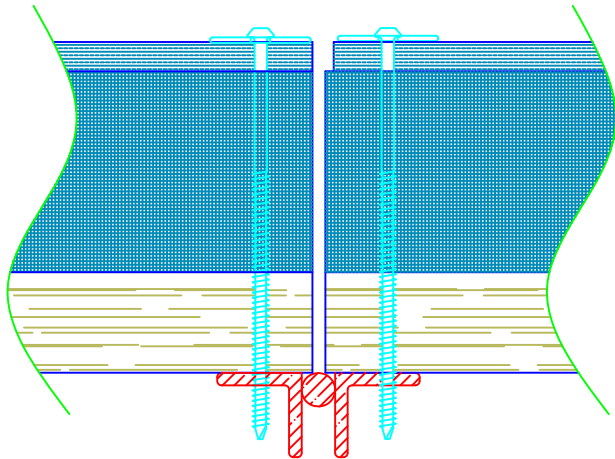

TECTUM III, E, AND NS
DECK USES DEKFAST #14
SCREWS WITH A 1 $\frac{1}{2}$ "
WASHER OR TRUFAST HD
SCREWS. PRE DRILLING IS
REQUIRED FOR 1/8" THICK OR
THICKER STEEL.

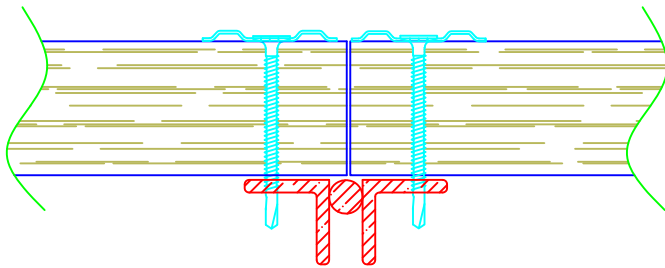

TECTUM I DECK USES EITHER
DEKFAST #14 SCREWS OR S - 25
SELF - DRILLING SCREWS. A 2"
DIAMETER WASHER IS REQUIRED.

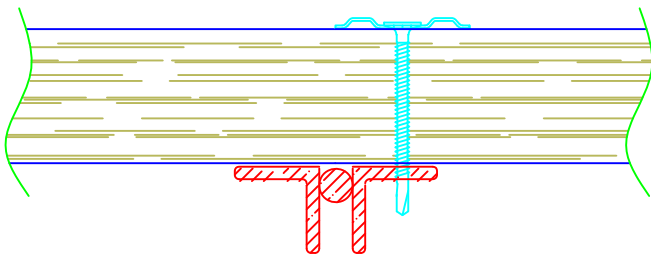

ONE ROW OF SCREWS IS
REQUIRED AT INTERMEDIATE
SUPPORTS.

NOTE : A 3/8" BEAD OF CONSTRUCTION ADHESIVE
IS REQUIRED WHEN SPECIFIED.

DECK SCREWED TO STEEL

DETAIL NUMBER:

2005

SCALE : NTS

Revised: 03/24/2016

TECTUM_{INC.}
The Noise Control Solution