

TECTUM III / E
ROOF PANEL

TRUFAST SCREW @ 12" O.C. TYP.

8D NAILS @ 6" O.C.
TOP OF SUBFASCIA
(U.N.O.)

2X SUBFASCIA
BY OTHERS

CONTINUOUS $\frac{3}{8}$ " BEAD
OF MASTERWELD 948
SEALANT TYP. EACH
SIDE

WALL BY OTHERS

VENTED SOFFIT PANEL
BY OTHERS

1X BY OTHERS

16D COATED NAILS
@ 6" O.C. BOTTOM OF
SUBFASCIA (U.N.O.)

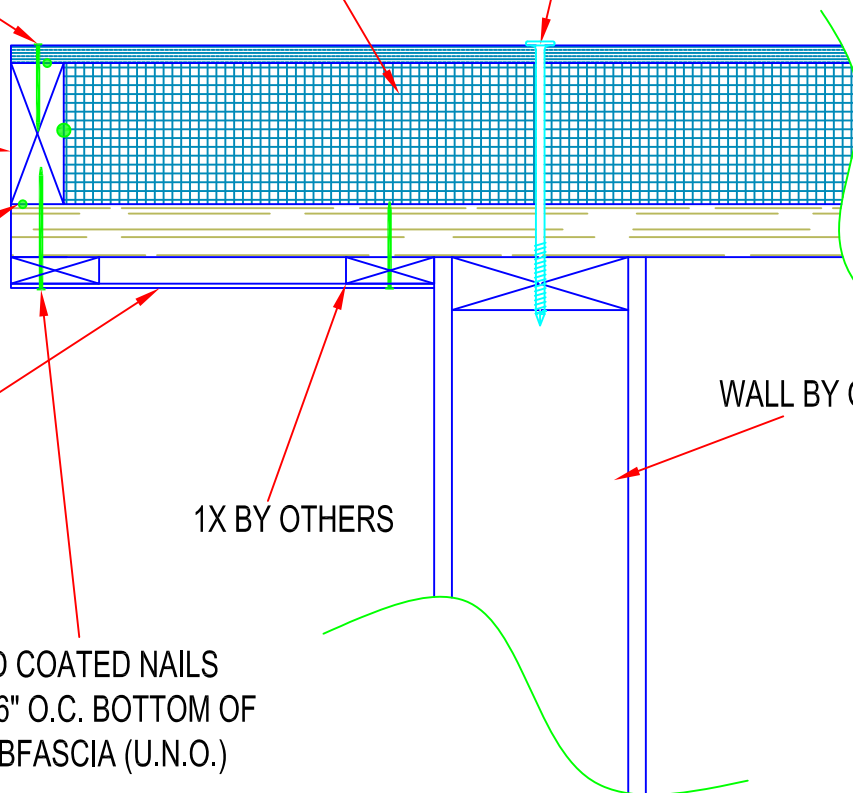

NOTE: OVERHANG DETAIL FOR TECTUM COMPOSITE PANELS. MAXIMUM OVERHANG FOR 5" OR THICKER PANELS IS 24". THE OVERHANG IS ALSO LIMITED TO 1/3 OF THE PANEL LENGTH OR WIDTH EXTENDING OVER THE WALL TO THE INSIDE. MAXIMUM OVERHANG ALONG PANEL WIDTH IS 16" WHEN A FULL WIDTH PANEL IS AT THE EDGE.

OVERHANG RAKE VENTED

DETAIL NUMBER:

2028

SCALE : NTS

Revised: 03/28/2016

TECTUM_{INC}

The Noise Control Solution